

Appendices 2

First Schedule

Trees specified individually

(encircled in black on the map)

<u>No. on Map</u>	<u>Description</u>	<u>NGR</u>	<u>Situation</u>
T1	Oak	408904-278458	Northern Boundary
T2	Oak	408783-278454	Western Boundary
T3	Oak	408857-278272	Main Body Of Site
T4	Ash	408816-278243	Main Body Of Site
T5	Ash	408843-278240	Main Body Of Site
T6	Oak	408930-278234	Main Body Of Site
T7	Ash	408973-278230	Main Body Of Site
T8	Ash	409000-278228	Main Body Of Site
T9	Oak	408740-278254	Northern Boundary
T10	Oak	408680-278250	Northern Boundary
T11	Oak	408666-278251	Northern Boundary
T12	Sycamore	408382-278104	Western Boundary
T13	Oak	409218-277921	Western Boundary
T14	Oak	409201-277904	Western Boundary
T15	Oak	4091880-277880	Close To Western Boundary
T16	Oak	409174-277877	Western Boundary
T17	Oak	409144-277853	Western Boundary
T18	Oak	409116-277829	Western Boundary
T19	Oak	409121-277799	South-Eastern Boundary
T20	Oak	409141-277804	South-Eastern Boundary
T21	Oak	409160-277811	South-Eastern Boundary
T22	Oak	409211-277828	South-Eastern Boundary
T23	Oak	409223-277841	Close To South-Eastern Boundary
T24	Beech	409270-278092	Main Body Of Site
T25	Oak	409284-278091	Main Body Of Site
T26	Oak	409391-278103	Main Body Of Site
T27	Oak	409407-278121	Main Body Of Site
T28	Pine	409091-278155	Main Body Of Site
T29	Oak	409087-278155	Main Body Of Site
T30	Oak	409080-278163	Main Body Of Site
T31	Beech	409112-278228	Main Body Of Site
T32	Sycamore	409264-278232	Main Body Of Site
T33	Silver Birch	409222-278246	Main Body Of Site

Appendices 2

Trees specified by reference to an area

(within a dotted black line on the map)

<u>No. on Map</u>	<u>Description</u>	<u>NGR</u>	<u>Situation</u>
-------------------	--------------------	------------	------------------

NONE

Groups of Trees

(within a broken black line on the map)

<u>No. on Map</u>	<u>Description</u>	<u>NGR</u>	<u>Situation</u>
-------------------	--------------------	------------	------------------

G1	Group of mixed species native trees Sycamore, Oak, Willow and Hawthorn	409050-278340	Linier Feature Running North To South
----	--	---------------	---------------------------------------

G2	Group of mixed species native trees Ash, Oak, Willow, Hawthorn and Malus	408943-278290	Linier Feature Running West To East
----	--	---------------	-------------------------------------

G3	1 x Ash 1 x Willow 1 x Sycamore 3 x Oak	408832-278512	Northern Boundary
----	--	---------------	-------------------

G4	3 x Oak 1 x Lime	408784-278354	Western Boundary
----	---------------------	---------------	------------------

G5	6 x Oak	408632-278257	Northern Boundary
----	---------	---------------	-------------------

G6	3 x Oak	408423-278267	Northern Boundary
----	---------	---------------	-------------------

G7	Group of mixed species native trees Ash, Oak, Hawthorn, Hazel and Malus	408630-277973	Liner feature on Souther Boundary running West to East.
----	---	---------------	---

Appendices 2

G8	Group of mixed species native trees Oak and Hawthorn	409026-278087	Linear Feature Running North To South
G9	Group of mixed species native trees Oak and Hawthorn	409214-277942	Southern Boundary
G10	6 x Alder 2 x Oak	409421-277865	Eastern Boundary
G11	Group of mixed species native trees Oak, Ash and Alder	409421278094	Eastern Boundary
G12	Group of mixed species native trees Oak, Alder and Hawthorn	409375-278243	Main body of site towards Northern boundary
G13	Group of mixed species native trees Oak, Alder, Ash and Silver Birch	409464-278338	Main body of site towards Northern boundary
G14	Main body of site towards Northern boundary	409534-278381	Northern Boundary of the site

Appendices 2

Woodlands

(within a continuous black line on the map)

<u>No. on Map</u>	<u>Description</u>	<u>NGR</u>	<u>Situation</u>
-------------------	--------------------	------------	------------------

NONE

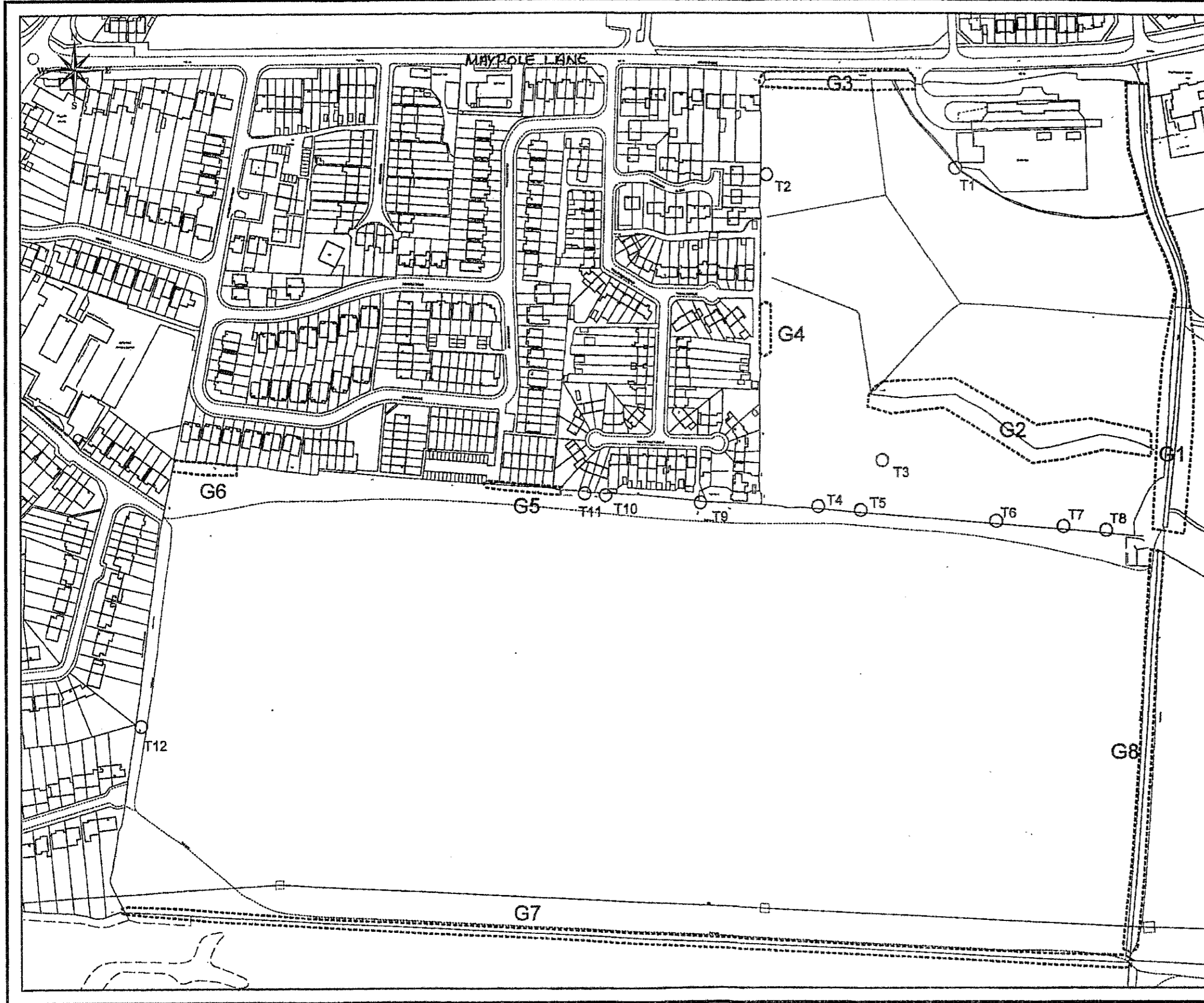

Project:
**Bromsgrove District
 Tree Preservation Order
 (19) 2014
 Plan (1)**

Drawing:
**Land Between
 Peterbrook Road, Maypole Lane
 and Gay Hill Golf Club
 HOLLYWOOD**

Drawn: AAA	Scale: 1:2300
Surveyed: AAA	Date: 19/09/2014

Drawing No: P2184/X

Environmental Services
 Town Hall
 Walter Stranz Square
 Redditch
 Worcs B98 8AH



© Crown Copyright and database rights 2014
 Ordnance Survey 100024252

S. Salles

19th september
 2014.

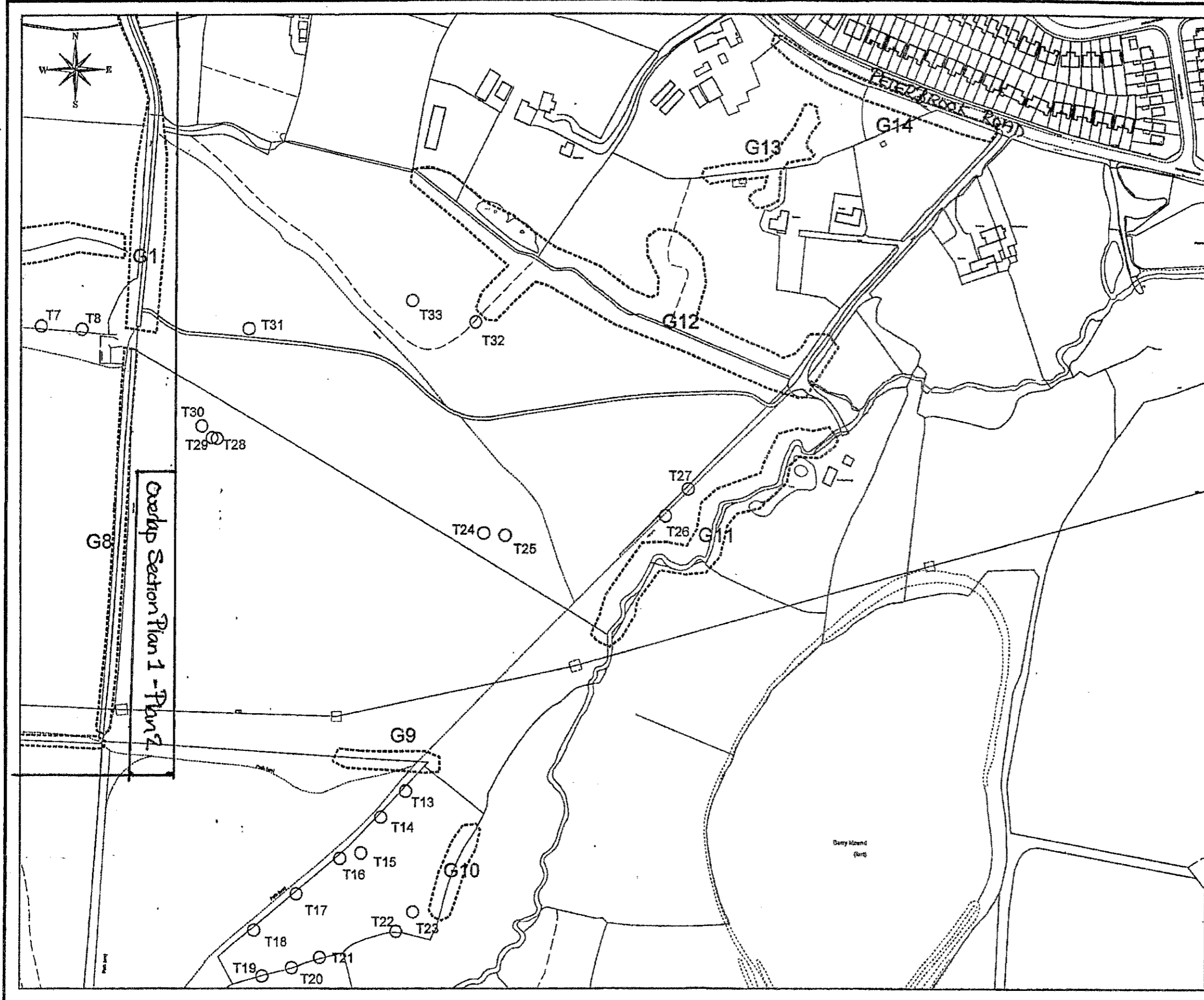

Project:
**Bromsgrove District
 Tree Preservation Order
 (19) 2014
 Plan (2)**

Drawing:
**Land Between
 Peterbrook Road, Maypole Lane
 and Gay Hill Golf Club
 HOLLYWOOD**

Drawn: AAA	Scale: 1/2300
Surveyed: AAA	Date: 19/09/2014

Drawing No: P2184/X

Environmental Services
 Town Hall
 Walter Stanz Square
 Redditch
 Worcs B98 8AH



© Crown Copyright and database rights 2014
 Ordnance Survey 100024252

S Sellers

19th September
 2014